

CONSTRUCTION NOTICE **MISSION COLLEGE CAMPUS**



PROJECT NAME: Mission College Electric Vehicle Charging Stations

ACTIVITY DESCRIPTION: Lot E Construction Fence Expansion

SCHEDULE: Monday, September 14, 2020 – Friday, October 23, 2020

CAMPUS IMPACT: Parking Lot E

Construction fence layout will be temporarily expanded for about 5 weeks due to trenching work that needs to occur. Parking Lot E will remain open while the Work is performed, but access to the Lot will be limited. A temporary vehicular alternate route will be established to enter and exit Lot E.

Please see the attached Campus map for Work plan and temporary alternate vehicular route.

PROJECT CONTACT: Rosa Huynh, MC Facilities Administrative Specialist
Rosa.Huynh@wvm.edu
(408) 855-5425

Susan Rittel, MC Director of Facilities Construction
Susan.Rittel@wvm.edu
(408) 855-5043

Brian Shively, MC Administrative Services, Program Specialist
Brian.Shively@missioncollege.edu
(408) 855-5289

Danny Nguyen, MC VP of Administrative Services
Danny.Nguyen@missioncollege.edu
(408) 855-5417

For more information regarding the Capital Improvement Program, please visit the Campus Construction Update page at: <https://wvm.edu/services/construction/Pages/default.aspx>

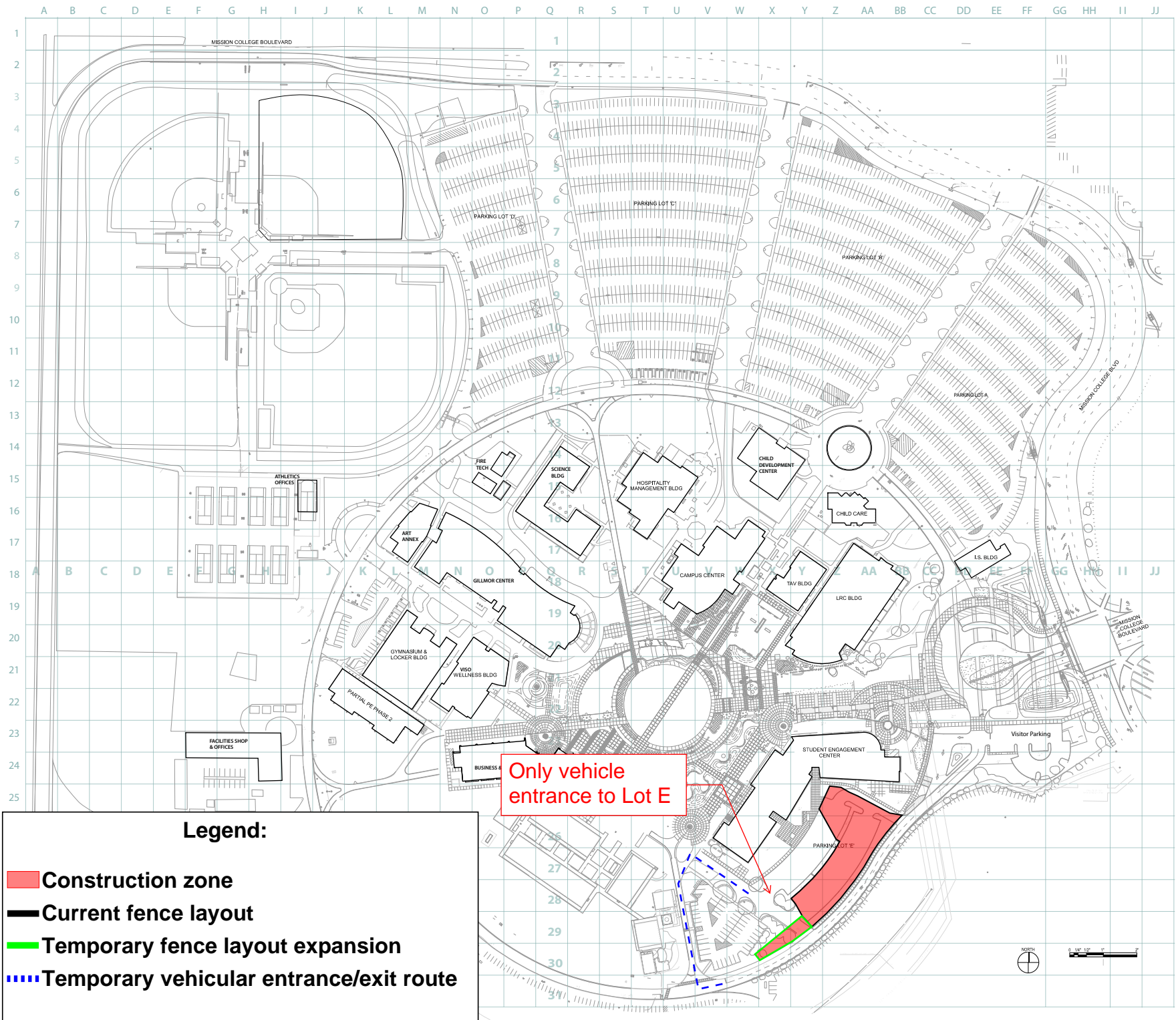

Legend:

- Construction zone
- Current fence layout
- Temporary fence layout expansion
- Temporary vehicular entrance/exit route

Only vehicle
entrance to Lot E

